

Smart Motion Sensor

USER MANUAL

M414-12Ever1.2

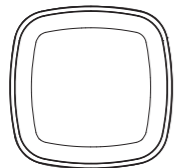

*Please read the user manual carefully before operation.
The guide pictures are for reference only.

PRODUCT INTRODUCTION

The ultimate solution to protect your home. Create your own home security system and create rules for automation.



TECHNICAL PARAMETERS

Working Voltage: 3VDC (1xCR123A battery)

Static current: $\leq 15\mu\text{A}$

Alarm current: $\leq 30\text{mA}$

Detecting angle: 90°

Install height: 2.1m

Detecting distance: 9~12m

Networking: ZigBee 1.2 Home Automation

Operation temperature: $-10^\circ\text{C}\sim+50^\circ\text{C}$

Relative humidity: Maximum 95%RH (No condensation)

Outline dimensions: 65x65x28.5mm

DETECTING AREAS

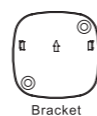
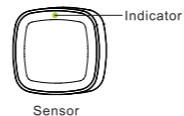
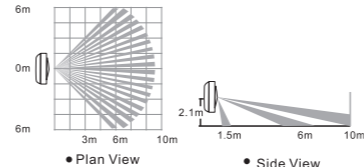

TIPS

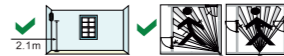

Please avoid outdoor installation, places with pets, air-condition, heat source nearby, places with direct sunshine and places under rotating objects. The installation surface should be solid without vibration.

Please install the sensor in the places where an intruder may pass easily.



STEP 1

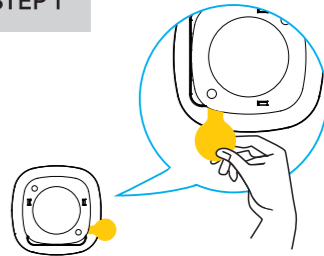

Remove the battery insulator from product to activate. Device will enter warm-up state when red LED flashes. After 30 seconds LED will turn off indicating warm-up is complete.

STEP 2



Click on the gear-symbol on your dashboard to add new device. Start device scan to search for new device.

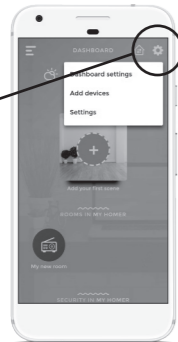

STEP 3

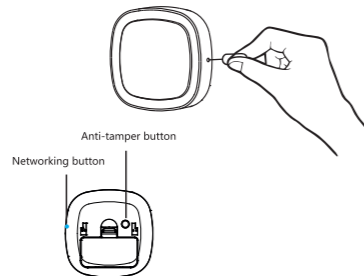

Add to gateway:

After starting the search in the APP, press network button (pin hole) for 3 seconds to enter inclusion mode. LED will flash rapidly until device are detected by your gateway, you will see the new device appear in the search results on your app.

Disconnect:

Press and hold the network button (pin hole) for 5 seconds to disconnect / reset the device. The LED will flash six times to indicate successfully disconnected / reset.

LED Indicator instruction of devices

Add network	Pressing network button for 2 seconds, green LED flash (twice per second)
Quit network	Green LED flash six times (once per second)
Alarm	Red LED flash one time

STEP 4

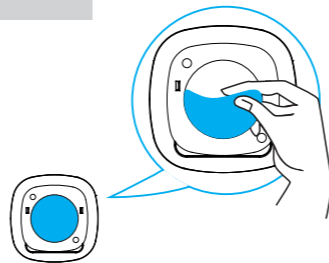

Mount the device in the area required after removing the protecting film of the double-side tape on the back side.

STEP 5

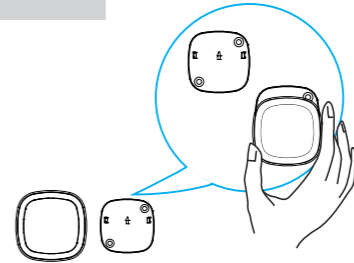

Note: Please keep arrow part in the picture upwards. Put the sensor into the bracket.

CHANGING BATTERY

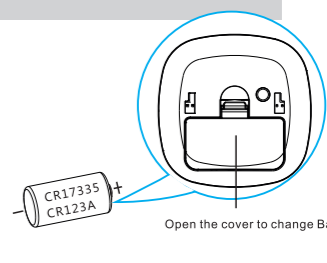

Open the cover to change Battery

Please change the battery according to negative and positive of the battery.

Please deal with waste batteries correctly for environmental protection.